



## STAINLESS STEEL TOP & POCKET PIVOTS

# PIVOTS

### 0180



- 3/4" offset
- Standard Duty

### 0180-1.5



- 1 1/2 " offset
- Standard Duty

### L0180



- 1-3/4" lead lined door
- Heavy Duty
- 3/4" offset top pivot
- Non-handed, full mortise
- Needle bearing supplied standard.
- US32D models UL listed for use on 3 hour doors.

### 0320

- Center Hung
- Medium Duty



### E0320

- Center Hung
- Standard Duty
- Electrified

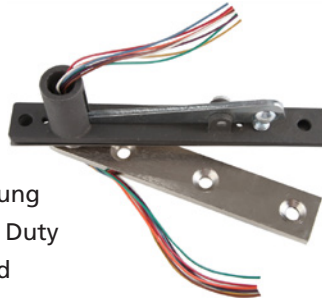

### 0923

- Full Surface
- Reinforcing Pivot



### 0321

- Center Hung
- Light Duty



### 0340

- Center Hung
- Heavy Duty

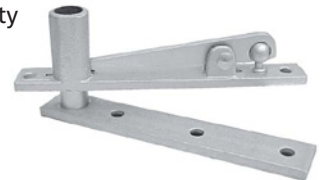

### E0340

- Center Hung
- Heavy Duty
- Electrified
- Top Pivot

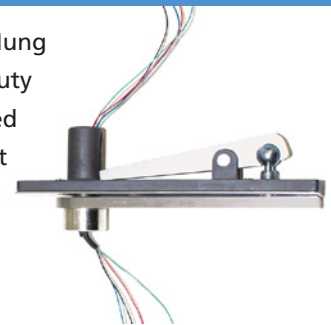

## STAINLESS STEEL POCKET PIVOTS

### 0519

- Pocket Door Pivot



### E0519

- Pocket Pivot
- Electrified

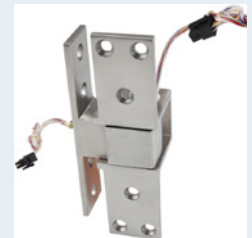

SEE SS PIVOT/PIVOT SETS CROSSOVER REFERENCE CHART ON PAGE 9

**International Door Closers, Inc.**

COPYRIGHT 2017 INTERNATIONAL DOOR CLOSERS, INC

**West: 800-544-4422 • East: 800-225-6737**

**www.intldoorclosers.com**



# CROSS REFERENCE CHART

## PIVOT/PIVOT SETS

STAINLESS STEEL PIVOT/PIVOT SETS CROSS REFERENCE CHART			
IDC	RIXSON	IVES	DORMA
0117 0117.25 0147	117 117-1/4 147	7226 7212 7226	OP440 - -
0147 x 1 1/2 L0147 0195	147 x 1 1/2 1147 195	7244F x 1 1/2 7230F 7215	OP15500 OPL440 OPJ350
0127 0128	127-3/4 128-3/4	7255J -	- -
0327 03701 0180	- 370 180/H180	- 7255 7215TOP	- CP440 75120
0180 x 1 1/2 L0180 0320	180 x 1 1/2/H180 x 1 1/2 L180 320	7244FTOP 7237FTOP -	15120 75140 -
0321 0340 E0340 019	- 340 EH340 M19/M190	- 7255TOP - 7215INT	- 8062 - 75220
019 x 1 1/2 E019 L019	M19 x 1 1/2 E-M19 ML19	7244FINT 7215PT 7230FINT	15233 75200 75240
0519 E0519	F519 EF519	91105F 91105FPT	75520 -