



GRADE 1 CYLINDRICAL LOCKS

TH-5000L

CYLINDRICAL LOCKSETS

Grade 1 Cylindrical Locks

IDC locksets are designed for commercial, industrial and institutional use, where dependable operation and longevity is required along with high resistance to vandalism and abuse. Applications include office buildings, government centers, factories, schools and hospitals and more.

Internal clutch provides vandal resistance by permitting lever rotation without retracting latch when locked.

Independent heavy duty springs provide effective lever return and support.



Design & Performance Features

Design

Strong stable design with anti-twisting capacity, dependable operation and longevity

Clutch

Internal clutch provides vandal resistance by permitting lever rotation without retracting latch when locked.

Handing

All M7200 series locksets are non-handed

Backset

2-3/4" backset standard. 2-3/8" (60mm) backset or 5" (127mm) backset extension optional

Faceplate

Brass, bronze or stainless steel. 1-1/8" x 2-1/4" (29mm x 57mm) square corner, beveled.

Chassis

Heavy gauge steel chassis, corrosion resistant zinc dichromate

Latch bolt and Roller Retractor

Stainless Steel, (13.7lbs) throw, deadlocking on keyed and exterior functions. The retractor is equipped with a roller to enhance reliability and long life.

Levers

Durable cast zinc based levers

Rose

Brass or stainless steel, 3-9/16" (90mm) diameter rose

Independent Lever Springs

A durable torsion spring on each side provides positive lever return and prevents lever sagging

Strike

ANSI curved lip strike, 1 1/4" x 4 7/8" x 1-3/8" lip to center standard

Door Thickness, field adjustable

Field adjustable for 1-3/8" - 1-3/4" (35mm - 45mm) thick door

Through Bolt Mounted

Trim assembly is through bolt mounted for superior strength.

Cylinders and Keys

6 pin type keyway with 2 brass keys standard.

Small Format Interchangeable Cores

Interchangeable Core will accept compatible 6 or 7 pin cores with BEST.

Certifications

ANSI / BHMA

ANSI/BHMA A156.2 Grade 1 strength and operational requirements

ANSI A250.13 severe windstorm compliant



UL Listed for 3 Hr 'A' label or lesser fire rated single doors, 4' x 8'

UL10C/UBC-2 positive pressure compliant

UL10B neutral pressure compliant

ADA







ADA/ANSI A117.1 accessibility code compliant

California State Reference Code (CSFM)

All levers, G and E, with less than 1/2" (13mm) return comply with California Fire Safety Codes (Formerly Title 19, California State Fire Marshal)

CYLINDRICAL LOCKSETS



FUNCTION	IDC	ANSI	DESCRIPTION
	10	F75	Passage or Closet Latch - Latch bolt operated by lever, from either side at all times
	40	F76	Privacy, Bedroom or Bath Lock – Latch bolt operated by lever from either side. Outside lever is locked by push button unlocked by emergency release outside, operating inside lever or closing door.
	53	F82	Entry Lock - Dead locking latch bolt operated by lever from either side except when outside lever is locked by push or turn button. When outside lever is locked, operating key in outside lever or operating inside lever unlocks push button and retracts latch bolt. Closing door does not release push button.
	70	F84	Classroom Lock - Dead locking latch bolt operated by lever from either side except when outside lever is locked from outside by key. When outside lever is locked latch bolt is operated by inside lever.
	80	F86	Storeroom or Closet Lock – Dead locking latch bolt operated by key in outside lever, or by operating inside lever. Outside lever is always inoperable.
	25	F111	Exit or Communicating Passage Lock – Dead locking latch bolt operated by lever one side only at all times. Non removable blank trim or no trim outside.
	170		Dummy Trim 1 Side - Used as door pull or as matching inactive trim

IDC Function

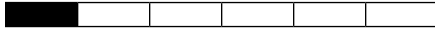

- 10** Passage
- 40** Privacy, Bedroom or Bath Lock
- 53** Entrance Lock
- 70** Classroom Lock
- 80** Storeroom
- 25** Communicating Passage Lock
- 170** Dummy Trim, 1 Side, Eclipse

Lever Trim

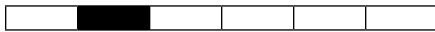

Mechanical Locksets



R Type



L Type



R-IC Type



L-IC Type

Finish



- | | |
|-----------------------|-----------------------|
| 626 Dull Chrome (std) | 613 Oil Rubbed Bronze |
| 605 Bright Brass | 606 Dull Brass |
| 611 Bright Bronze | 612 Dull Bronze |
| 625 Bright Chrome | |

Latch bolt

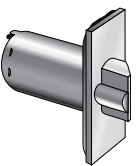

Deadlatch

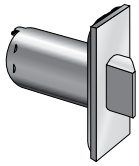

Springlatch

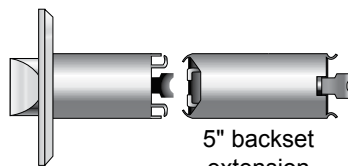

5" backset extension

- B1** 2-3/4" dead latch (standard)
- B2** 2-3/8" dead latch

- B3** 2-3/4" spring latch, passage (standard)
- B4** 2-3/8" spring latch, passage

- B5** 2-3/4" spring latch, privacy (standard)
- B6** 2-3/8" spring latch, privacy

- BE** 5" backset extension, for use with 2-3/4" latch only

How to Specify

Strike

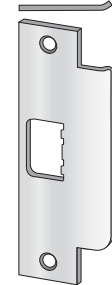
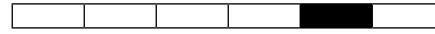

ST1



ST2

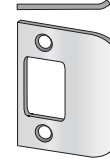

ST3

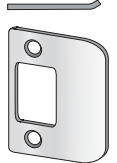

ST4

- ST1** ANSI 1-1/4" x 4-7/8" (Standard)
- ST2** T-Strike with dust box, ANSI 1-1/8" x 2-3/4"
- ST3** Full lip strike, 1-5/8" x 2-1/4"
- ST4** Full lip strike with round corners, 1-5/8" x 2-1/4"

Cylinder or I-Cores

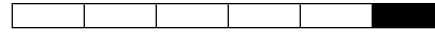

- IDC Conventional Cylinders (Schlage 'C' Keyway Standard)
For R-IC or L-IC Type
- 6PKA** 6 PIN Keyed alike
- 6PKD** 6 PIN Keyed different (standard)



IC

- IDC Interchangeable Core (Best 'A' Keyway Standard)
For G5 and E5 levers
- IC6P-KA** 6 pin I-Core, small format, keyed alike
- IC6P-KD** 6 pin I-Core, small format, keyed different
- IC7P-KD** 7 pin I-Core, small format, keyed different
- IC7P-KA** 7 pin I-Core, small format, keyed alike