



PREMIUM PUSH PLATES 6" PUSH PLATES

PBR SERIES

PREMIUM PUSH PLATES FOR KNOWING ACT APPLICATIONS

PBR SERIES



10PBR
Push To Open
Text Only



10PBR1
Push To Open
Text and Logo



10PBRLL
Handicap
Logo Only

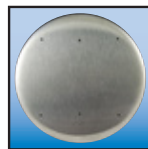

10PBR10
Plain Face
No Graphic



10PBR1 shown with optional surface mount box
(All mounting options are sold separately)

The PBR series is a standard 6 inch round push plate with a premium design for wall applications, as well as functional, aesthetically appealing and weather resistant.

COMPONENTS VIEW

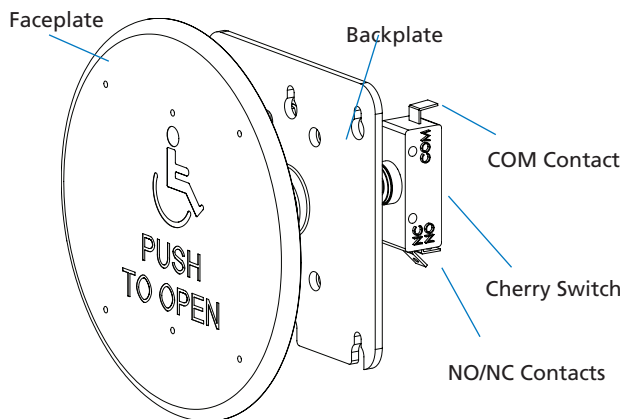

FEATURES

- Larger surface area for high visibility
- Beveled edges are less susceptible to damage by deflecting harsh impacts from any side
- Stainless steel finish is scratch/scuff resistant and will not deteriorate or rust from exposure to liquids and other cleaning agents
- Graphics are etched onto the faceplate for maximum durability
- Available in various styles to fit almost any application, hard wired or wireless

International Door Closers, Inc.

COPYRIGHT 2017 INTERNATIONAL DOOR CLOSERS, INC

West: 800-544-4422 • East: 800-225-6737

www.intldoorclosers.com

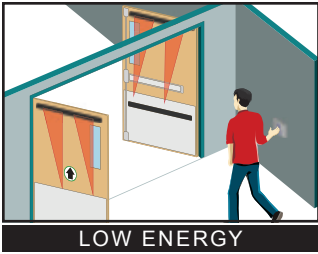

APPLICATIONS

BENEFITS

- Grade 304 stainless steel maximizes corrosion resistance and prevents rusting
- Stainless steel materials are 100% recyclable and environmentally friendly
- Options include hard wired and wireless mounting
- Compatible wireless frequencies include 433, 390 or 300 MHz

MOUNTING ACCESSORIES



10BOX6RND5M
Surface Mount



10BOX6RND5M
Flush Mount

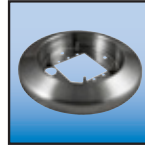

10ESCUTCHEON
Stainless Steel
Surface Mount

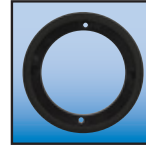

10WRRND6
6 inch
Weather Ring

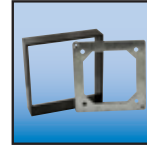

10PBBRACKET
Surface
Mount Kit

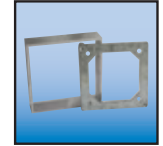

10PBBRACKETCA
Clear Anodized
Surface Mount

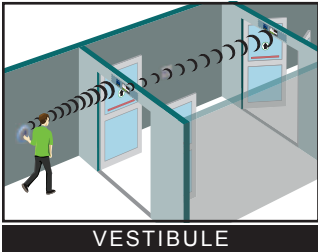

DIMENSION DETAILS

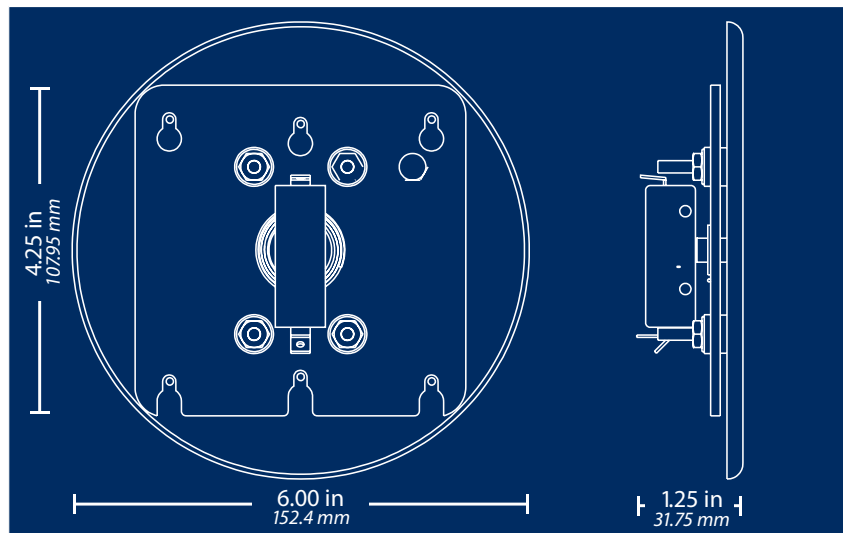

BACK

SIDE

TECHNICAL SPECIFICATIONS

Materials	Faceplate: 16 gauge, 304 2B Stainless Steel
	Backplate: 1/8 inch thick, Aluminum
Cherry Switch	Mounting Screws: Stainless Steel, 6-32 x 1 in & 8-32 x 1 in
	Allen Head Size: 5/64
Compatible Wireless Frequencies	Single-pole, 15 A, COM/NO/NC
	433, 390 or 300 MHz

Specifications are subject to change without prior notice.

DISCLAIMER This document as well as all other enclosed documents (quotation / specification / other) are provided «as is» without warranties of any kind, either expressed or implied, including but not limited to the implied warranties of merchantability, fitness for a particular purpose, or non-infringement. / Information is supplied upon the condition that the persons receiving it will make their own determination as to its suitability for their purposes prior to use. In no event will IDC be responsible for damages of any nature whatsoever resulting from the use of or reliance upon information from this document or the products to which the information refers. / IDC has the right without liability to change descriptions and specifications at any time. / Prices, shipping and availability are subject to change without prior notice.

